

BreatheX CPAP Device

User Manual

Hoffman Laboratories, LLC.

Chatsworth, CA 91311



[Click Here & Upgrade](#)
Expanded Features
Unlimited Pages

PDF
Complete

Contents

INDICATIONS FOR USE	7
SAFETY INFORMATION	7
WARNINGS AND CAUTIONS	7
PRECAUTIONS FOR USE	10
INTRODUCTION	11
OVERVIEW	11
DEVICE DESCRIPTION	12
COMPONENTS	12
OPERATION	14
GETTING STARTED	17
CHARGING THE BATTERY	17
SELECTING AND ASSEMBLING THE MASK	18
ATTACHING THE TUBING AND MASK	18
POSITIONING OF THE BREATHEX DEVICE	19
CHANGING THE BATTERY	20
CHANGING THE SETTINGS	22
CONTROL PANEL	22

SETTING THE ALTITUDE COMPENSATION.....	23
TURNING RAMP ON/OFF	24
READING THE HOUR METER	25
USING THE BREATHEX DEVICE.....	26
CLEANING, MAINTENANCE, & STORAGE	27
GENERAL GUIDELINES.....	27
MASK	27
TUBING	27
OUTER CLOTH COVER	27
STORING THE BREATHEX DEVICE.....	28
AIR INLET FILTER	28
TROUBLESHOOTING.....	29
BREATHEX DEVICE SPECIFICATIONS	32
EMC STATEMENT.....	34
LIMITED WARRANTY	36
INDEX	37
ABOUT HOFFMAN LABS.....	38
REPLACEMENT PARTS.....	39



[Click Here & Upgrade](#)
Expanded Features
Unlimited Pages

PDF
Complete

Indications for Use

The BreatheX™ device provides continuous positive airway pressure (CPAP) and is intended for the treatment of obstructive sleep apnea (OSA) in spontaneously breathing adults weighing at least 30 kg.

NOTE: Federal law restricts this device to sale by or on the order of a physician.

Safety Information

Important! Before using the BreatheX CPAP device, carefully read this entire manual, including the accessory directions for use as well as all precautionary information.

Warnings and Cautions

This manual will include warnings, cautions and notes throughout.



A WARNING symbol indicates the possibility of serious injury to yourself or others.



A CAUTION symbol indicates the possibility of minor injury or damage to the equipment.



The following are warnings unless otherwise specified:

- This device is not intended for life support.
- The BreatheX device is a single patient use device; use only for your own CPAP therapy as directed by your physician. Do not use this equipment until your sleep professional has set the pressure level.

This CPAP system should be used only with CPAP masks recommended by your physician or respiratory therapist. A mask should not be used unless the CPAP system is turned on and operating properly. The exhalation device should never be blocked.

Explanation of the Warning: CPAP systems are intended to be used with special masks with connectors which have vent holes or separate exhalation



devices to allow continuous flow of air out of the mask. When the CPAP machine is turned on and functioning properly, new air from the CPAP machine flushes the exhaled air out through the attached mask exhalation port. However, when the CPAP machine is not operating, enough fresh air will not be provided through the mask, and exhaled air may be rebreathed. Rebreathing of exhaled air for longer than several minutes can in some circumstances lead to suffocation. This warning applies to most models of CPAP systems.

- The BreatheX device should be used only with masks and connectors with a suitable exhalation port as recommended by Hoffman Laboratories, LLC, or your sleep professional. A mask should not be used unless the CPAP machine is turned on and operating properly.
- At low CPAP pressures, the flow through the exhalation port(s) of the mask may be inadequate to clear all exhaled gas from the tubing. Some rebreathing may occur.
- Do not expose the battery to high temperatures (greater than 140°F/60°C)
- Do not impact, pierce, crush or disassemble the battery. Dispose of the battery thoughtfully, in compliance with local regulations, when battery is exhausted.
- While wearing the device, you should NOT sleep facing down on the bed.
- Keep the BreatheX device dry at all times. Do not use the unit where it can come in contact with water.
- This CPAP machine should be used only with tubing provided by Hoffman Laboratories or recommended by your sleep professional.
- Contact your physician immediately if you experience problems such as sinus drainage or discomfort, ear pain, daytime sleepiness, mood changes, memory lapse, nasal or airway dryness, irritability, or disturbance of your sense of direction.
- Do not smoke or use an open flame near a CPAP device.



The following are cautions unless otherwise specified.

- Do not operate the unit without an air inlet filter installed.
- Keep the air inlet clear at all times during operation.
- Never insert any object into the air inlet, hoses, or mask.
- Never operate the unit where the air inlet can be blocked.

- Never block the small vent openings in the mask or exhalation port. This ensures that exhaled air is purged to prevent rebreathing of carbon dioxide (CO₂).
- The airflow for breathing produced by the BreatheX device can be as much as 6 °F (3 °C) higher than the temperature of the room. Exercise caution if the room temperature is warmer than 90 °F (32 °C).
- This device is not intended to be used as a pillow or to replace a pillow.
- Risk of electrical shock. Do not disassemble the battery charger of the BreatheX device. Refer servicing to qualified personnel.
- Keep the BreatheX device and accessories away from heaters and heated surfaces.
- Never operate the device if it is damaged in any way. Refer to an authorized service center.
- Contact your equipment provider if the device malfunctions in any way. Only qualified service personnel should service the BreatheX device.
- Hoffman Laboratories offers no instructions for use of supplemental oxygen with its CPAP device.
- Hoffman Laboratories does not recommend this unit to be used with oxygen.
- Hoffman Laboratories does not recommend this unit to be used with a humidifier
- Do not sterilize or apply disinfectant to the BreatheX device.
- Recharge the BreatheX device using only a battery charger supplied by Hoffman Laboratories.
- When changing the battery, follow the instructions in this manual. Use only a battery specified by Hoffman Laboratories.
- Discontinue the use of the BreatheX device if you experience skin irritation or other discomfort during use.
- If you intend to use the BreatheX device at altitudes above 6000 ft (1830 m), contact your equipment provider. Your pressure settings may need to be adjusted
- Patients with implanted biomedical electronic devices such as cardiac demand pacemakers should consult their physician before using this CPAP device.



Precautions for Use



The BreatheX CPAP device should be used with caution if you have any of the following conditions:

- Pneumothorax
- Severe bullous lung disease
- Pathologically low blood pressure
- Dehydration
- Cerebrospinal leak/recent cranial surgery or trauma

Introduction

Overview

Continuous positive airway pressure (CPAP) has become the first line of treatment for obstructive sleep apnea (OSA). CPAP delivers a prescribed level of pressurized air to the user and acts as an air splint to hold the upper airway open during use. This therapy is safe and effective, and has been shown to improve sleep quality, daytime alertness, and quality of life.

Learning how the device functions and how to properly fit the mask helps to ensure maximum comfort and use. It is also important that you have access to a sleep professional in case you have questions or concerns regarding treatment.

The BreatheX CPAP device is an innovative product that allows more freedom of movement during use. The device is a battery operated CPAP unit, meaning there is no power cord attached to the unit during treatment. The device uses only a short tube between the CPAP unit and the mask, causing less pulling on the mask than with a conventional longer hose. This can improve the mask fit and comfort, especially while you change positions during sleep.

For further information about sleep disorders:

American Sleep Apnea Association (ASAA)

1424 K Street NW, Suite 302
Washington, DC 20005
Phone: (202) 293-3650
Fax: (202) 293-3656
www.sleepapnea.org

National Sleep Foundation (NSF)

1522 K Street, NW, Suite 500
Washington, DC 20005
Phone: (202) 347-3471
Fax: (202) 347-3472
www.sleepfoundation.org



Device Description

Components

The BreatheX CPAP device includes the following components:

1. **CPAP Device**

Offering a unique design and fit, the BreatheX device rests comfortably over the user's shoulders.



This device is not intended to be used as a pillow or to replace a pillow. Support the head normally as you would during sleep.

2. **Tubing/Mask System**

The mask and tubing connect to the device's air outlet connector. For detailed information about the mask, refer to the manufacturer's documentation.

3. **Air Outlet Connector**

The air outlet connector connects the tubing to the CPAP unit.

4. **Battery Charger**

The battery charger is used to charge the CPAP unit's battery from an AC outlet when the device is not in use.

The battery charger may be connected to a 12V DC source using a commercially available inverter.

5. **Carry Bag**

A carry bag is provided with the BreatheX device.

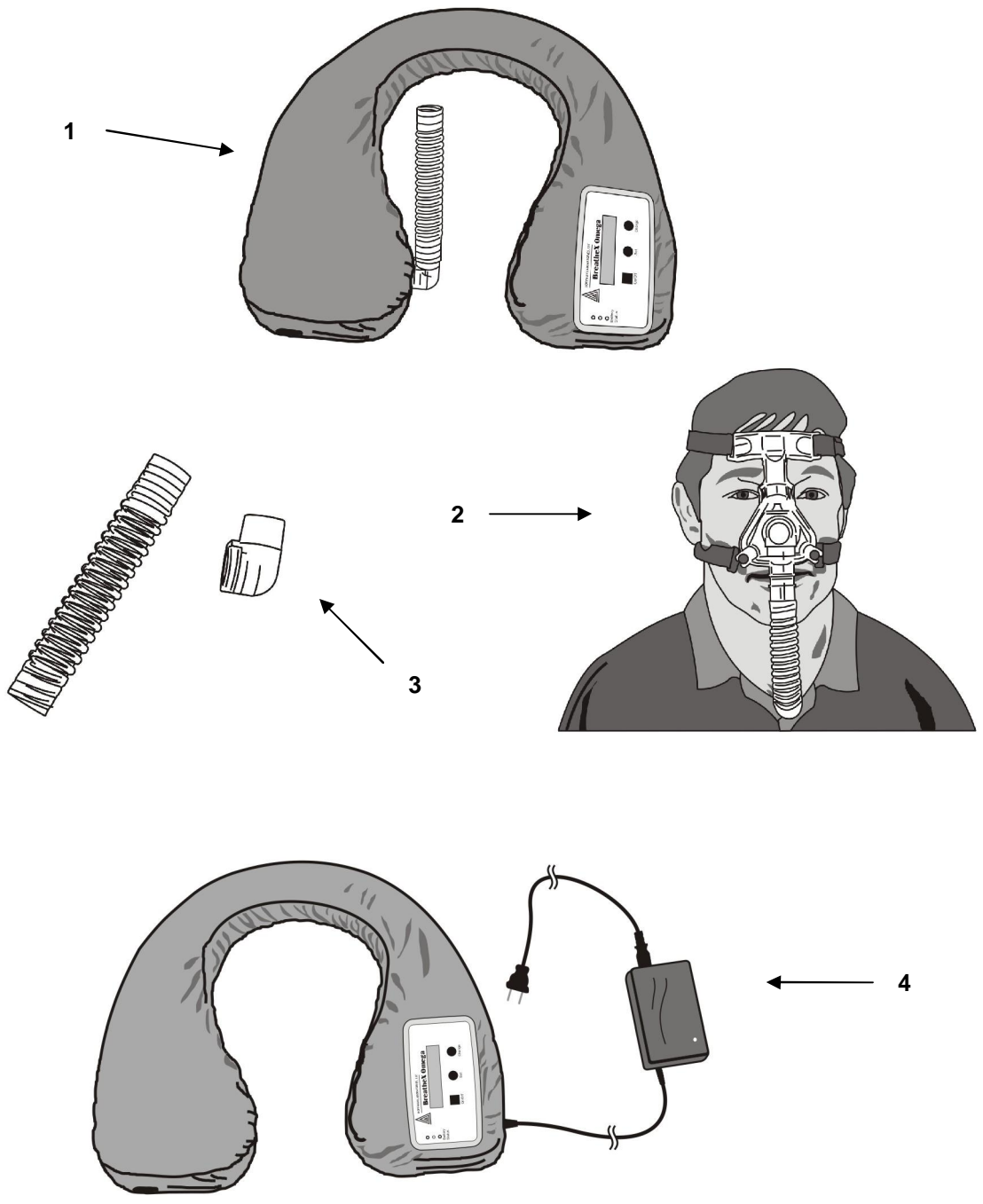

Operation

6. On/Off Button

The On/Off button is a square black button located on the Control Panel. Pressing this button turns the device on or off.

7. Set Button

Use this button primarily for moving through menus and accessing the ramp, altitude compensation, and hour meter settings.

8. Change Button

This button works in conjunction with the Set button and allows settings to be turned on/off.

9. Battery Status Indicators (LED's)

The Battery Status Indicators display the current level of the battery charge:

- 3 LEDs = 95% charge
- 2 LEDs = 75% charge
- 1 LEDs = 60% (or less) charge

NOTE: It is recommended that the device only be used when all 3 LEDs are lit.

10. Low Battery Alarm

The device comes with a low battery alarm. If the battery charge is reduced such that only 10 minutes of operation are left on the charge, then an audible alarm will sound. This alarm can be turned off by pressing the On/Off button.

11. Charge Port

The battery charger plugs into the Charge Port to recharge the BreatheX devicer. When the device is charging, the battery status will display on the charger.

NOTE: When you are charging the device, you cannot activate the On/Off button until the battery charger is unplugged from the Charge Port.

12. Air Inlet Port

Air enters the CPAP unit through the air inlet port.

13. Air Inlet Filter

The air inlet filter covers the air inlet port.

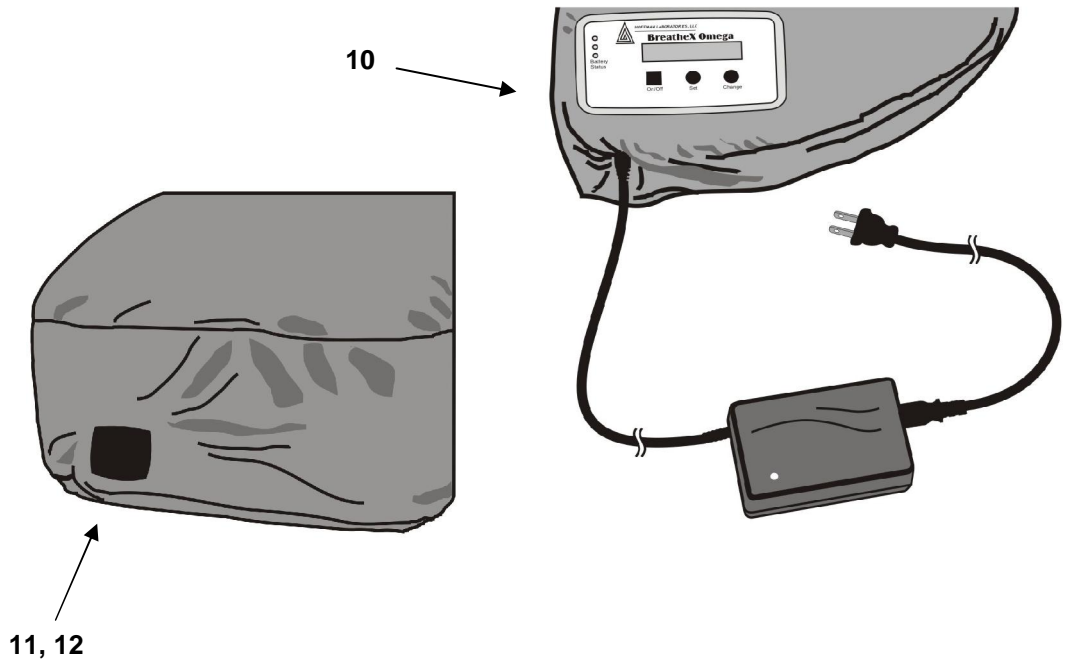
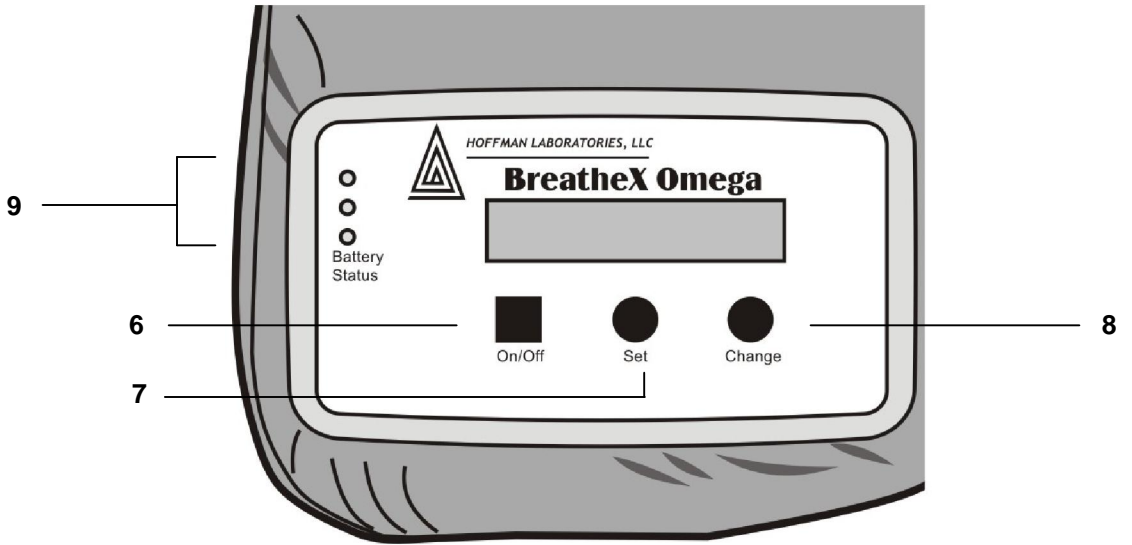

Getting Started

Remove the BreatheX device from its packaging. Be sure all the components are included and carefully examine each component for any damage. The components consist of the following:

- BreatheX CPAP unit
- Tubing
- Air outlet connector
- AC battery charger
- Carry bag

Charging the Battery

Connect the battery charger cord to the BreatheX device's **Charge Port** and then plug the other end of the battery charger into a wall outlet.

Once the battery is charged, simply unplug the CPAP unit from the charger.

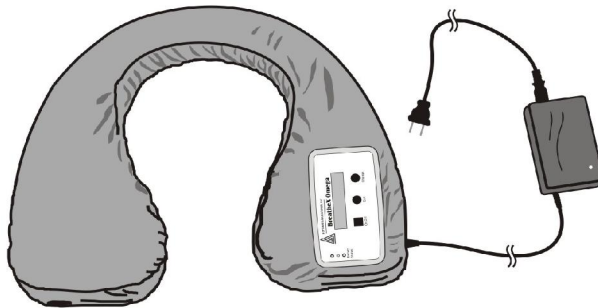

It will take approximately 5 hours to fully charge the battery from a discharged condition. **You should fully charge the battery before the first use.**

The battery should be recharged daily or after each use.

When the battery is fully charged it will provide approximately 11 hours of use at 10cm H₂O pressure.

During battery charging the indicator light on the charger will change from red to orange to green. A green indicator light indicates that the device is fully charged and ready for use.



When the device is turned on, the LEDs will light up and indicate the current level of the battery charge

- 3 LEDs = 95% charge
- 2 LEDs = 75% charge
- 1 LED = 60% (or less) charge

NOTE: While the battery is charging, the device cannot be turned on

It is recommended that the device only be used when all 3 LEDs are lit.

If the battery charger light is not changing as indicated within the 5-hour period, the battery may need to be replaced.

The device does have a low battery alarm. If the battery charge is reduced such that only 10 minutes of operation are left on the charge, then an audible alarm will sound. This alarm can be turned off by pressing the On/Off button.

The battery charger may be connected to a 12V DC source using a commercially available inverter.

Selecting and Assembling the Mask

Your sleep professional will supply a mask for use with the BreatheX device. Please use the mask according to the manufacturer's instructions.

Attaching the Tubing and Mask

Connect the tubing to your mask, and then rotate the air outlet connector to the desired position. The air outlet connector can accommodate a range of tubing positions to make mask fit more comfortable and stable. The optimal position of the swivel joint should be determined during mask fitting. Ensure that the tubing is firmly connected to the mask and air outlet connector.

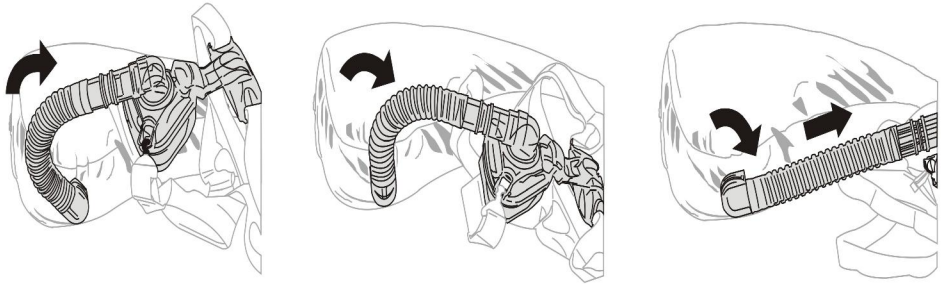

Positioning of the BreatheX Device

You have several options for positioning the BreatheX device using either the 8" tubing or 21" tubing, and you may choose whichever is most comfortable for you. We encourage you to try the BreatheX device in several positions to determine what works best for you.

The device may be placed comfortably over your shoulders and closed at the front with the fastener strap as shown below.

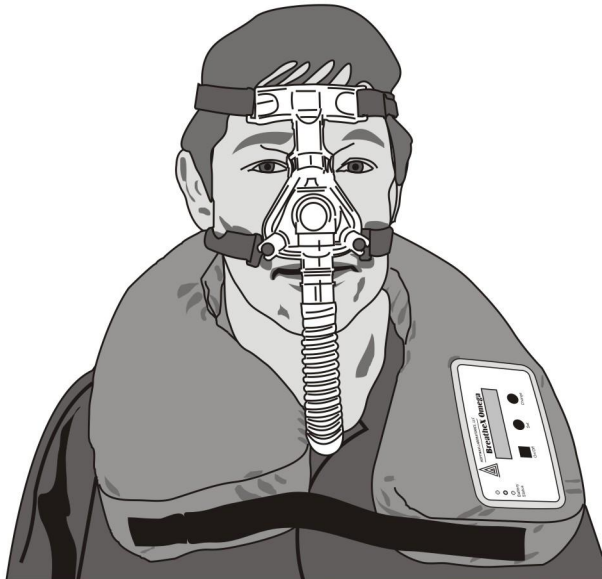

With the 21" tubing, you may use the BreatheX device in a number of positions as suggested in the diagrams below.

NOTE: The device was not designed to be used in place of a pillow. Your pillow normally used during sleeping should provide any needed head support. If you find that the BreatheX device interferes with the support provided by your pillow, please consult your sleep professional.



While wearing the device, you should NOT sleep facing down on the bed.

Changing the Battery

The BreatheX device allows you to replace the battery as required. The device should be turned off before the battery is removed.

Lift up the device's outer cloth, pull out the battery pack, and insert the new battery. To remove or insert the battery, use the tabs provided on the top and bottom of the battery box.

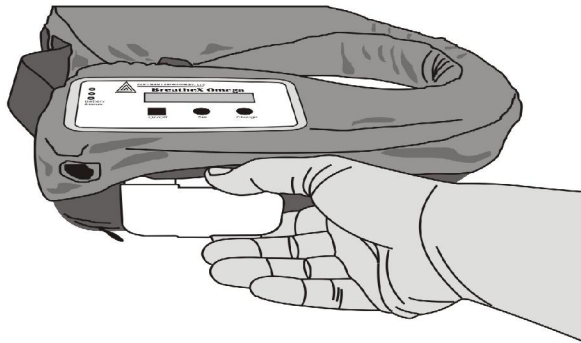

You may also purchase additional batteries in order to operate the device for multiple evenings when it is not possible to recharge the batteries, for example if you intend to use the device on a camping trip.



Do not expose the battery to high temperatures (greater than 140°F/60°C).



Do not impact, pierce, crush or disassemble the battery.

Recharge the BreatheX device using only a battery charger supplied by Hoffman Laboratories.

When changing the battery, follow the instructions in this manual. Use only a battery specified by Hoffman Laboratories.

DC inverters (120 watts minimum), enabling the charger to be used with a 12V DC outlet, are commercially available.

The user may also purchase additional batteries in order to operate the device for multiple evenings when it is not possible to recharge the batteries, for example if he or she intends to use the device on a camping trip.

Changing the Settings

Control Panel

Located on top of the CPAP device, the Control Panel lets you turn the device On/Off and, using a combination of buttons, change the settings, as well as review battery charge status.

When the device is turned on the LCD will show the current software version, the altitude compensation setting, the ramp setting and usage hours, and will cycle through these settings 3 times. The LCD will then go blank.

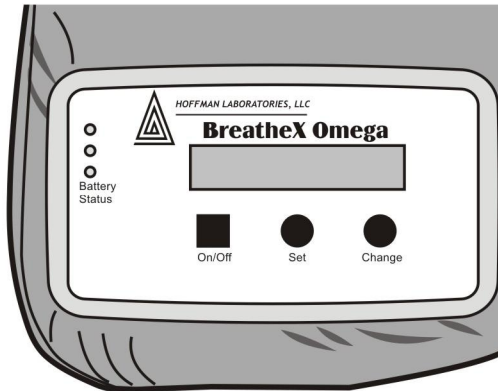

Use the main display to change the settings

NOTE: The display options will only appear when the device is powered on.

NOTE: When the device is being charged, it cannot be turned on/off. The battery charger must be disconnected from the device's Charge Port before operating the device.

Setting the Altitude Compensation

The Altitude Compensation should be set to the **Off** option if the CPAP device is to be used at altitudes from 0-3000 ft (914m). For altitudes between 3000 feet (914m) and 6000 feet (1830m), the Altitude Compensation should be **On**. If you intend to use the BreatheX device at altitudes above 6000 ft (1830 m), contact your equipment provider.

1. Turn the device on by pressing the **On/Off** button. The LCD will scroll through the altitude compensation, ramp and hour settings; the LCD will then turn off.
2. At any time after turning the device on, press and hold the **Set** button for **3 seconds** until **Alt Comp** is displayed (airflow will stop at this time).
3. To change the option, press the **Change** button.
4. To save this option, press the **Set** button **3 times**, which will then turn on the airflow, scroll through the settings, and turn off the LCD. The device is then ready to use.

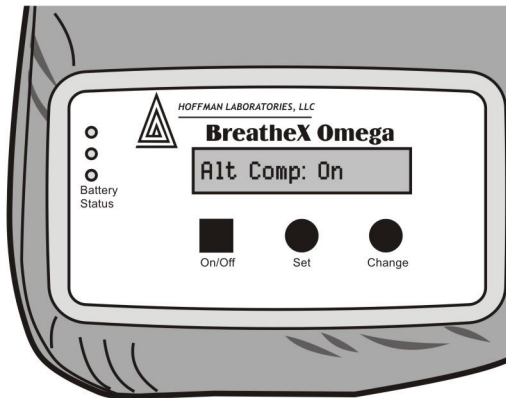

Turning Ramp On/Off

The ramp feature allows your treatment to start at a lower pressure than the prescribed pressure. The pressure will increase to the prescribed pressure over a 15-minute time period.

1. Turn the device on by pressing the **On/Off** button. The LCD will scroll through the altitude compensation, ramp and usage hours settings. The LCD will then turn off.
2. At any time after turning the device on, press and hold the **Set** button for **3 seconds** until **Alt Comp** is displayed (airflow will stop at this time).
3. Press the **Set** button **once** until the **Ramp** option is displayed.
4. To change the option, press the **Change** button.
5. To save this setting, press the **Set** button **twice**, which will then turn on the airflow and scroll through the settings. The device is then ready for use.

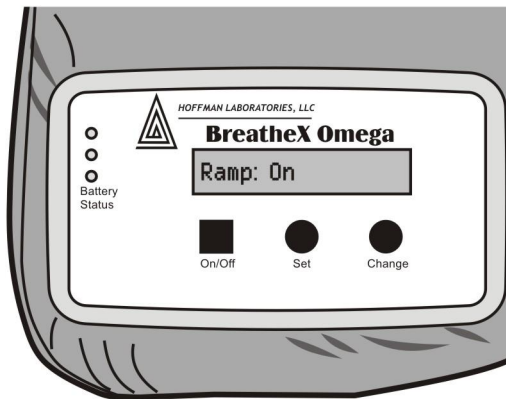

Reading the Hour Meter

The hour meter will display total use time, information that may be requested by your sleep professional.

As the LCD cycles when the device is turned on, the usage hours will be displayed. If you need to see the detail again, either turn the device off and on again, or follow these instructions.

1. Turn the device on by pressing the **On/Off** button. The LCD will scroll through the altitude compensation, ramp and usage hours settings; the LCD will then turn off.
2. At any time after turning the device on, press and hold the **Set** button for **3 seconds** until **Alt Comp** is displayed (airflow will stop at this time).
3. Press the **Set** button **twice** until the **Usage Hours** option is displayed.
4. After reading usage hours, press the **Set** button **once**, which will then turn on the airflow and scroll through the settings. The device is then ready for use.

Using the BreatheX Device

When you are ready to start treatment, be sure your mask and device are comfortably positioned, and press the On/Off button to start delivering the air pressure. If you are using the ramp option and need to restart it, just press the On/Off button twice. The device will turn off and on again.

If you need to get up during the night, you do not need to disconnect the mask or device.

Diagram of person in bed with device on.



Cleaning, Maintenance, & Storage

General Guidelines

To prolong the life of your BreatheX device, be sure to properly clean and store it according to the following guidelines.

Mask

It is recommended that you clean and store the mask according to the mask manufacturer's instructions.

Tubing

Wash the tubing daily in warm water and a mild detergent, such as unscented Palmolive. Rinse the tubing thoroughly with cold water and allow the tubing to air dry out of direct sunlight before re-use. . The tubing should be inspected after each cleaning, and the tubing should be replaced if it contains cracks, tears, or extensive discoloration.



Do not use bleach, chlorine, alcohol, aromatic based solutions, moisturizing or antibacterial soap, or scented oils to clean the tubing. These solutions may cause damage and/or reduce the life of the product.

Outer Cloth Cover

To change or wash the BreatheX device's outer cloth cover, first remove the air outlet connector by turning its locking screw one-half turn anticlockwise and removing the air outlet connector. Then unzip and remove the cover.

The outer cover should be **hand washed** in lukewarm water with a standard detergent, such as Tide, rinsed in cold water and dried flat, out of direct sunlight. The outer cover should be washed at least once a week.



NOTE: The inner cover and contents should not be removed or washed.



Storing the BreatheX Device

Store the device in a cool dry place, away from temperature extremes and humidity.



Keep the entire unit out of direct sunlight and heat as they may cause the product to deteriorate.

Air Inlet Filter

To prolong the life of the BreatheX device, the disposable air inlet filter needs to be replaced periodically, preferably every month. If the device is frequently exposed to dust, change the filter more frequently.

Open the mesh compartment on the left side of the device and remove the filter. Then replace with a new filter and close the compartment.



To prevent damaging the device or rendering the filter inoperable, do not wash the filter strip. Also, in humid environments, fungi could grow inside the filter. Be sure to inspect and replace the filter according to the instructions.

Troubleshooting

Problem	Possible Cause	Action
Device will not operate.	<p>Batteries discharged.</p> <p>Battery charger is still connected to device and is charging.</p>	<p>Check battery status LEDs and recharge if necessary.</p> <p>Disconnect charger from device.</p>
Sore or inflamed skin under the mask	<p>Mask is applied too tight.</p> <p>Reaction to mask material</p>	<p>Adjust the mask for a looser fit.</p> <p>Contact your sleep professional for other mask choices.</p>
Device operates for too short a time (not a full night's sleep).	<p>Batteries are not charged sufficiently.</p> <p>Battery life is depleted by use.</p>	<p>Be sure to charge batteries a minimum of 4 hours after each use.</p> <p>Contact your service provider to replace the battery.</p>
Battery Charger indicator light does not change from red to orange to green.	Battery life is depleted by use.	Contact your service provider to replace the battery.
Battery Status Indicators (LEDs) do not all light up after system has been fully charged.	Battery life is depleted by use.	Contact your service provider to replace the battery.



Problem	Possible Cause	Action
System fault indication on main display	<p>Mask and tubing are not properly connected.</p> <p>Unit has internal malfunction.</p>	<p>Make sure mask and tubing are properly attached, and recycle power button. If the problem still persists, contact your service center about repair of your unit.</p> <p>Contact your service center about repair.</p>
The device is delivering air that is too warm.	<p>The room temperature is too high.</p> <p>The air inlet filter may be dirty. The air inlet is clogged.</p>	<p>Lower the thermostat for the room. Make sure the BreatheX r is away from any heat source.</p> <p>Clean or replace the filter as described in this manual's <i>Air Inlet Filter</i> section. Move any linen, bedding or clothing away from the BreatheX device.</p>
The device is not delivering the correct pressure.	<p>The ramp is activated.</p> <p>It is being used at altitude.</p>	<p>Check whether the ramp function is on. Refer to this manual's <i>Turning Ramp On/Off</i> section.</p> <p>Need to set the altitude compensation setting.</p>
Discomfort that is due to a feeling that the pressure is too high	Set pressure of BreatheX device.	<p>Adapting to the nasal pressure can take a while. Try using the ramp function. This will slowly increase the pressure over a period of 15 minutes.</p> <p>If the pressure is not suitable for you, contact your sleep professional.</p>

Problem	Possible Cause	Action
Audible alarm is sounding	Battery has reached a state of charge which is 10 minutes or less.	Pressing On/Off button will turn off alarm and the unit. The device should then be put on Hoffman supplied charger to fully charge unit.

BreatheX Device Specifications

The following are specifications for the BreatheX CPAP device:

BreatheX Device Performance

Pressure range	5 cmH ₂ O to 12 cmH ₂ O adjustable by increments of 0.5 cm H ₂ O
Maximum achievable pressure at the patient connection port under single fault condition	30 cmH ₂ O
Ramp time	0 or 15 minutes – selectable
Sound level measured in accordance with ISO 17510-1:2001	31 dBA
Maximum sound level	31 dBA at 10 cmH ₂ O
Operating Period	11 hours with operation at 10 cm H ₂ O

Physical Characteristics

Dimension (W x H x L)	14 x 12 x 4 inches (35.6 x 30.5 x 10 cm)
Weight	4 lbs (1.8 kg)

Transport and Storage Conditions

Temperature Range	-20° C to + 60 ° C (- 4 ° F to +140 ° F)
Relative Humidity	Up to 95% without condensation
Atmospheric pressure range	500 hPa to 1060 hPa (1 hecto-Pascal ~ 1cmH ₂ O)

Conditions of Use

Temperature	+5° C to + 38° C (+41° F to + 100° F)
Relative humidity	Between 10 % to 95 % without condensation
Atmospheric pressure range	800 hPa to 1060 hPa
Operating altitude	0 to approximately 6000 ft (0-1830 m)

Disposal of the BreatheX Device at the end of its life

In order to protect the environment, various parts of the equipment and its accessories are to be disposed of in conformity with local regulations.

Electrical characteristics of the AC power supply module

Battery charger	Input Voltage: 100-240 VAC ($\pm 10\%$), 50/60 Hz (± 1 Hz)
-----------------	--

EMC Statement

Manufacturer's Declaration - Electromagnetic Emissions:

IEC 60601-1-2 Group I Class B;

Guidance and manufacturer's declaration, electromagnetic emissions		
<p>The BreatheX device is intended for use in the electromagnetic environment specified below. The customer or the user of the BreatheX device should assure that it is used in such an environment.</p>		
Emissions test	Compliance	Electromagnetic environment – guidance
RF emissions CISPR 11	Group 1	The BreatheX device uses RF energy only for its internal functions. Therefore, RF emissions are very low and are not likely to cause any interference to nearby electronic equipment.
RF emissions CISPR 11	Class B	The BreatheX device is suitable in all establishments, including domestic establishments and those directly connected to public low-voltage power supply networks that supplies buildings used for domestic purposes.
Harmonic emissions IEC 61000-3-2	Class A	
Voltage fluctuations/flicker emissions IEC 61000-3-3	Complies	
RF emissions CISPR 14-1	Complies	The BreatheX device is suitable for use with approved accessories. The BreatheX device is not suitable for interconnections with other equipment.

Guidance and manufacturer's declaration, electromagnetic emissions (continued)

The BreatheX device is intended for use in the electromagnetic environment specified below. The customer or the user of the BreatheX device should assure that it is used in such an environment. This device is not intended to be used as life supporting equipment.

Immunity test	IEC 60601 test level	Compliance level	Electromagnetic environment – guidance
Electrostatic discharge (ESD) IEC 61000-4-2	±6 kV contact ±8 kV air	±6 kV ±8 kV	Floors should be wood, concrete or ceramic tile. If floors are covered with synthetic material, the relative humidity should be at least 30%.
Bursts IEC 61000-4-4	±2 kV power supply lines ±1 kV input/output	±2 kV	Mains power supply quality for battery charging should be that of a typical hospital or commercial environment.
Surges IEC 61000-4-5	±1 kV differential mode ±2 kV common mode	±1 kV differential mode	Mains power supply quality for battery charging should be that of a typical domestic or hospital environment.
Voltage dips, short interruptions and voltage variations on power supply input lines in accordance with table 2004	>95% in $U_T/0,5$ cycles 60% dip in $U_T/5$ cycles 30% dip in $U_T/25$ cycles >95% in $U_T/5$ cycles	Complies	Mains power supply quality for battery charging should be that of a typical domestic or hospital environment.
Magnetic field Power frequency (50/60) Hz Magnetic field IEC 61000-4-8	3 A/m	3 A/m	Power frequency magnetic fields should be at levels characteristics of a typical location in a typical domestic or hospital environment.
Conducted RF IEC 61000-4-6	10 V 150 kHz - 80 Hz 10 V for life-supporting 150 kHz - 80 MHz inside ISM bands	10 V	Portable and mobile communications equipment should be used no closer to any part of the BreatheX Device , including cables, than the recommended separation distance calculated from the equation applicable to the frequency of the transmitter: $d = 1,17 \sqrt{P}$ [m]; where P is the maximum output power rating of the transmitter in watts[W].
Radiated RF IEC 61000-4-3	10 V/m 26 MHz - 2,5 GHz	10 V/m	$d = 1,17 \sqrt{P}$ [m] 26 MHz - 800 MHz $d = 2,3 \sqrt{P}$ [m] 800 MHz - 2,5 GHz Portable and mobile communications equipment should be used no closer to any part of the BreatheX device , including cables, than the recommended separation distance calculated from the equation applicable to the frequency of the transmitter.

Limited Warranty

Hoffman Laboratories, LLC. warrants the BreatheX CPAP device and its accessories to be free from defects in material and workmanship for the following periods from the date of purchase or lease by the initial consumer.

BreatheX CPAP Device	2 years
Battery and Battery Charger	1 year

Hoffman Laboratories shall repair or replace, at its option, the defective product or any of its components that Hoffman Laboratories determines to have been defective. To qualify for such repair or replacement, the defective product must be returned, at the consumer's expense, to an authorized repair facility. Products repaired under warranty shall be returned, freight prepaid, to a dealer designated by the consumer. This Limited Warranty does not cover damage caused by intentional or accidental misuse of the product, including any use of the product contrary to warnings or cautions contained in the User Manual.

This warranty is in lieu of all other express or implied warranties, including any implied warranty of merchantability or fitness for a particular purpose. Some regions or states do not allow limitations on how long an implied warranty lasts, so the above limitations may not apply to you.

Hoffman Laboratories shall not be responsible for any incidental or consequential damages claimed to have occurred as the result of the sale, installation or use of any its products. Some regions or states do not allow the exclusion or limitation of incidental or consequential damages, so the above limitation may not apply to you. This warranty gives you specific legal rights, and you may also have other rights which vary from region to region.

For further information on your warranty rights, please contact Hoffman Laboratories directly.

9305 Eton Avenue, Chatsworth, CA 91311

(818) 341-4131



Index

A

air inlet filter · 28
altitude compensation · 23

B

battery status · 14, 18
breathing tube · 12

C

change button · 14
charge port · 14
components · 12

D

device performance · 32

H

hour meter · 25

M

mask
assembling · 12

O

on/off button · 14
outer cloth cover · 27
outlet connector · 12

P

physical characteristics · 32

R

ramp · 24
replacement parts · 39

S

set button · 14
storing the device · 28

T

transport and storage conditions · 32

W

wearing device · 19



About Hoffman Labs

Hoffman Laboratories, LLC designs, develops, manufactures, and markets products focused on addressing the clinical needs of the respiratory market. Our goal is to take respiratory products to the next level by increasing the quality, comfort and cost-effectiveness of treatment.

Our flagship product, the BreatheX device, capitalizes on our patented motor-blower technology as the foundation for a unique and innovative product solution. Designed to be portable, lightweight, flexible, comfortable, and quiet, the BreatheX device truly gives people with sleep apnea the “Freedom to Sleep.”

For more information about Hoffman Laboratories, contact us at:

Hoffman Laboratories, LLC.
9305 Eton Avenue
Chatsworth, CA 91311
(800) xxx-xxxx
<http://www.breathex.net>
info@breathex.net

Replacement Parts

<u>Item</u>	<u>Part Number</u>
BreatheX CPAP Device (entire system)	322
BreatheX CPAP Device (CPAP unit only)	000-0001
Therapy Tubing, 6 inch	550-0001
Air Outlet Adaptor	570-0001
Battery	540-0001
Battery Charger	540-0002
Air Filter (package of 4)	514-0001

Replacement parts should only be purchased from Hoffman Laboratories, LLC or a Hoffman Laboratories, LLC designated distributor/service center.